

FOR LEASE | ± 34,313 SF

High Image Industrial Building

14271 Corporate Drive, Garden Grove, CA



PROPERTY FEATURES

- High Image Industrial Unit
- Part of a Larger ±59,876 SF Building
- ± 13,125 SF Two-Story Office
- ± 21,188 SF Production Warehouse Area
- 2 Truckwell Loading Door Positions
- 2 Grade Level Doors
- 24' Minimum Ceiling Height
- Fenced Yard Area
- .45/3,000 GPM Sprinkler System
- 800 Amps; 277/480 Volt .3 Phase Power (Verify)
- Excellent West Orange County Location
- Great Access to the 22, 405, 57 & 5 Freeways



MIKE BOUMA, SIOR
Senior Vice President
714.935.2340
mbouma@voitco.com
Lic. #01070753

PAUL CAPUTO, MBA
Senior Vice President
714.935.2332
pcaputo@voitco.com
Lic. #01196935

Voit
REAL ESTATE SERVICES

BOUMA • CAPUTO
for Success in Commercial Real Estate

FOR LEASE | ± 34,313 SF

High Image Industrial Building

14271 Corporate Drive, Garden Grove, CA

SITE PLAN

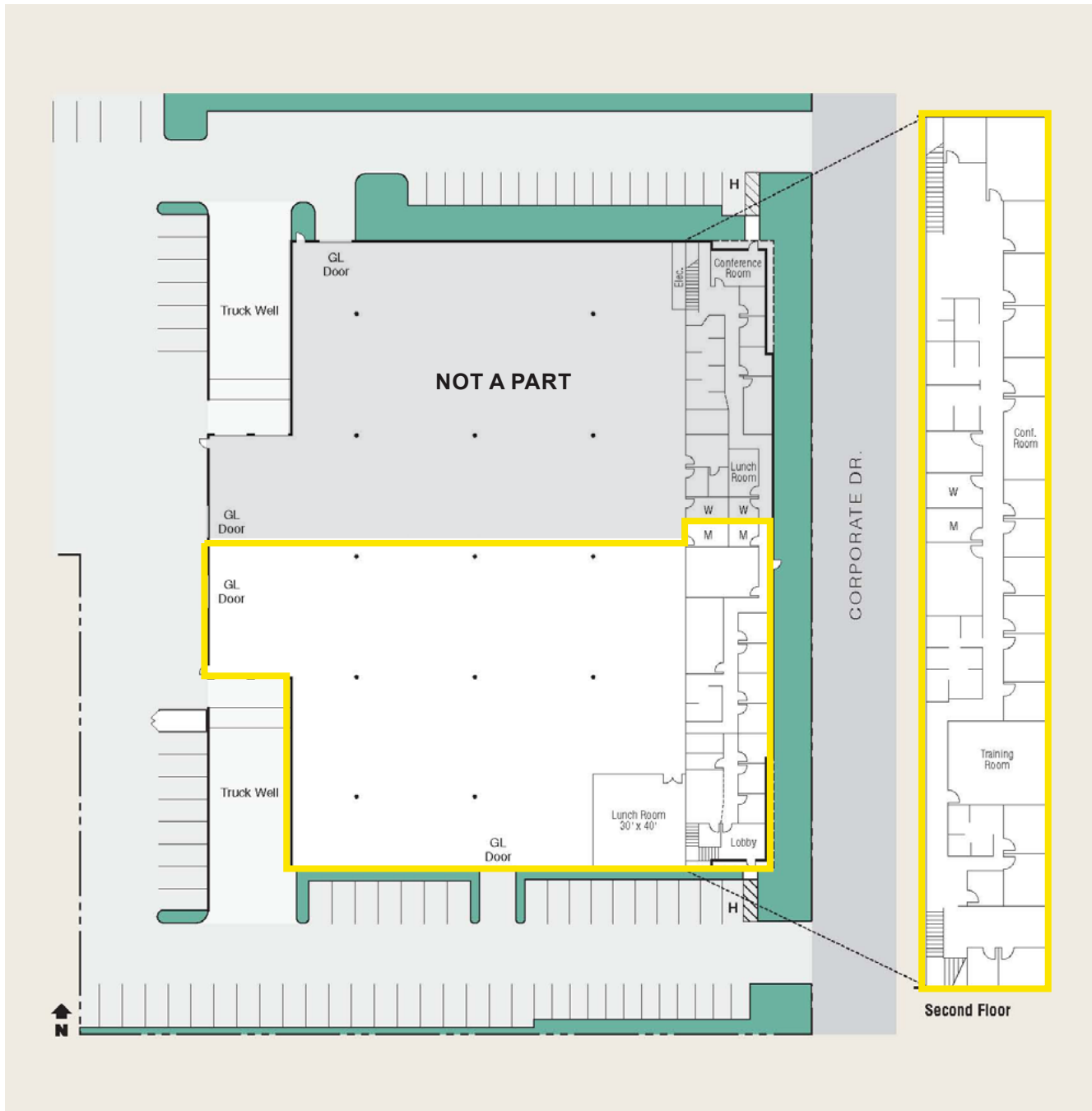

*Site plan not to scale

MIKE BOUMA, SIOR
Senior Vice President
714.935.2340
mbouma@voitco.com
Lic. #01070753

PAUL CAPUTO, MBA
Senior Vice President
714.935.2332
pcaputo@voitco.com
Lic. #01196935

Voit
REAL ESTATE SERVICES

BOUMA • CAPUTO
for Success in Commercial Real Estate

2400 E. Katella Ave., Suite 750, Anaheim, CA 92806 • 714.978.7880 • 714.978.9431 Fax • Lic #01991785

Licensed as Real Estate Salespersons by the DRE. The information contained herein has been obtained from sources we deem reliable. While we have no reason to doubt its accuracy, we do not guarantee it. ©2021 Voit Real Estate Services, Inc. All Rights Reserved.