

FOR SUBLEASE | ± 13,491 SF

14231 Commerce Drive, Garden Grove, CA



±6,231 SF OF COOLER, FREEZER & FOOD PROCESSING SPACE

PROPERTY FEATURES

- ± 13,491 SF Freestanding High Image Building
- ± 1,100 SF of Office Space
- ± 1,428 SF of Cooler, ± 3,953 SF of Freezer & ± 850 SF of Food Processing Space Installed in 2014 (Equipment Available For Sale By Prior Tenant)
- Clarifier in Place
- 22' Warehouse Clearance (20' Clearance in Cooler & Freezer)
- Small Yard Area
- 1 Ground Level Door
- 2 Dock High Positions (Rare)
- 400 Amps; 277/480 Power
- 25 Parking Spaces (Verify)
- Fire Sprinklered
- Excellent Access to the 22 and 405 Freeways
- Sublease Through August 14, 2021, Longer Term Possible



MIKE BOUMA, SIOR
Senior Vice President
714.935.2340
mbouma@voitco.com
Lic. #01070753

PAUL CAPUTO, MBA
Senior Vice President
714.935.2332
pcaputo@voitco.com
Lic. #01196935

Voit
REAL ESTATE SERVICES

BOUMA • CAPUTO
for Success in Commercial Real Estate

FOR SUBLEASE | ± 13,491 SF

Freezer / Cooler & Food Processing Facility
14231 Commerce Drive, Garden Grove, CA

SITE PLAN

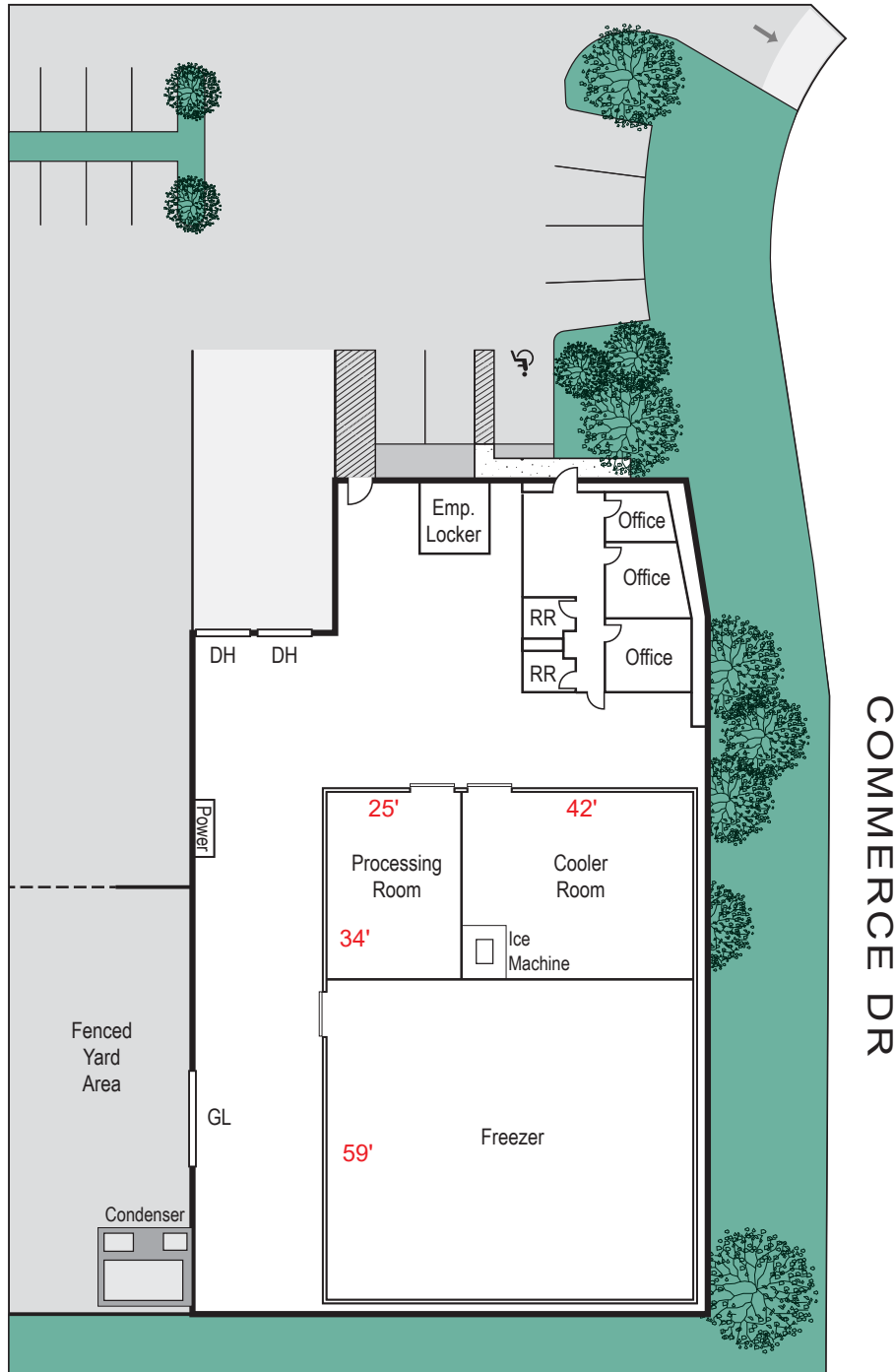

*Site plan not to scale

MIKE BOUMA, SIOR
Senior Vice President
714.935.2340
mbouma@voitco.com
Lic. #01070753

PAUL CAPUTO, MBA
Senior Vice President
714.935.2332
pcaputo@voitco.com
Lic. #01196935

Voit
REAL ESTATE SERVICES

BOUMA • CAPUTO
for Success in Commercial Real Estate

2400 E. Katella Ave., Suite 750, Anaheim, CA 92806 • 714.978.7880 • 714.978.9431 Fax • Lic #01991785

Licensed as Real Estate Salespersons by the DRE. The information contained herein has been obtained from sources we deem reliable. While we have no reason to doubt its accuracy, we do not guarantee it. ©2020 Voit Real Estate Services, Inc. All Rights Reserved.