

# FOR SALE OR LEASE | ± 4,274 SF

3622 Briggeman Drive, Los Alamitos, CA



## PROPERTY FEATURES

- ± 4,274 SF High Image Industrial Condominium
- ± 920 SF Office Area
- Newer Construction - Built in 2007
- 1.9/1,000 SF Parking Ratio (*Buyer to Verify*)
- ± 18' Warehouse Clearance
- One (1) Oversized Ground Level Door (12'w x 14'h)
- Fully Fire Sprinklered
- 200 Amps of Power, 120/208 Volt (*Buyer to Verify*)
- Excellent West Orange County Location
- Great Access to  ,  and  Freeways

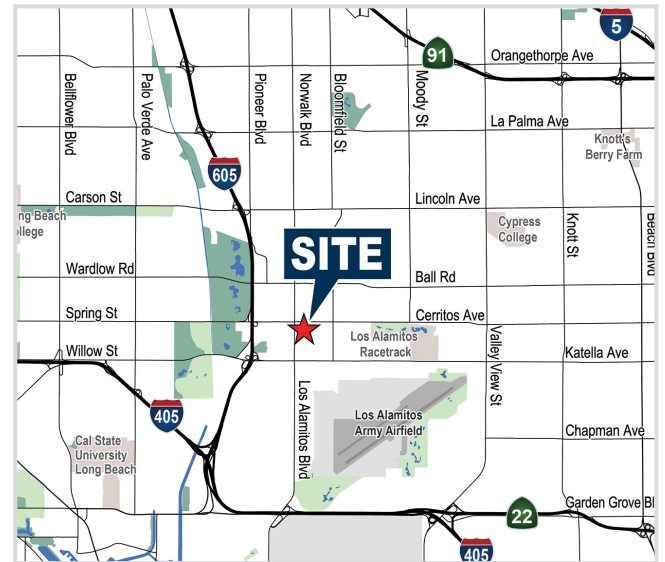

**MIKE BOUMA, SIOR**  
Senior Vice President  
714.935.2340  
mbouma@voitco.com  
Lic. #01070753

**SEBASTIAN LOZANO**  
Associate  
714.935.2303  
slozano@voitco.com  
Lic. #02143474

**LOREN CARGILE**  
Vice President  
714.935.2306  
lcargile@voitco.com  
Lic. #01434329

**Voit**  
REAL ESTATE SERVICES

# FOR SALE OR LEASE | ± 4,274 SF

3622 Briggeman Drive, Los Alamitos, CA

## FLOOR PLAN

BRIGGEMAN DR

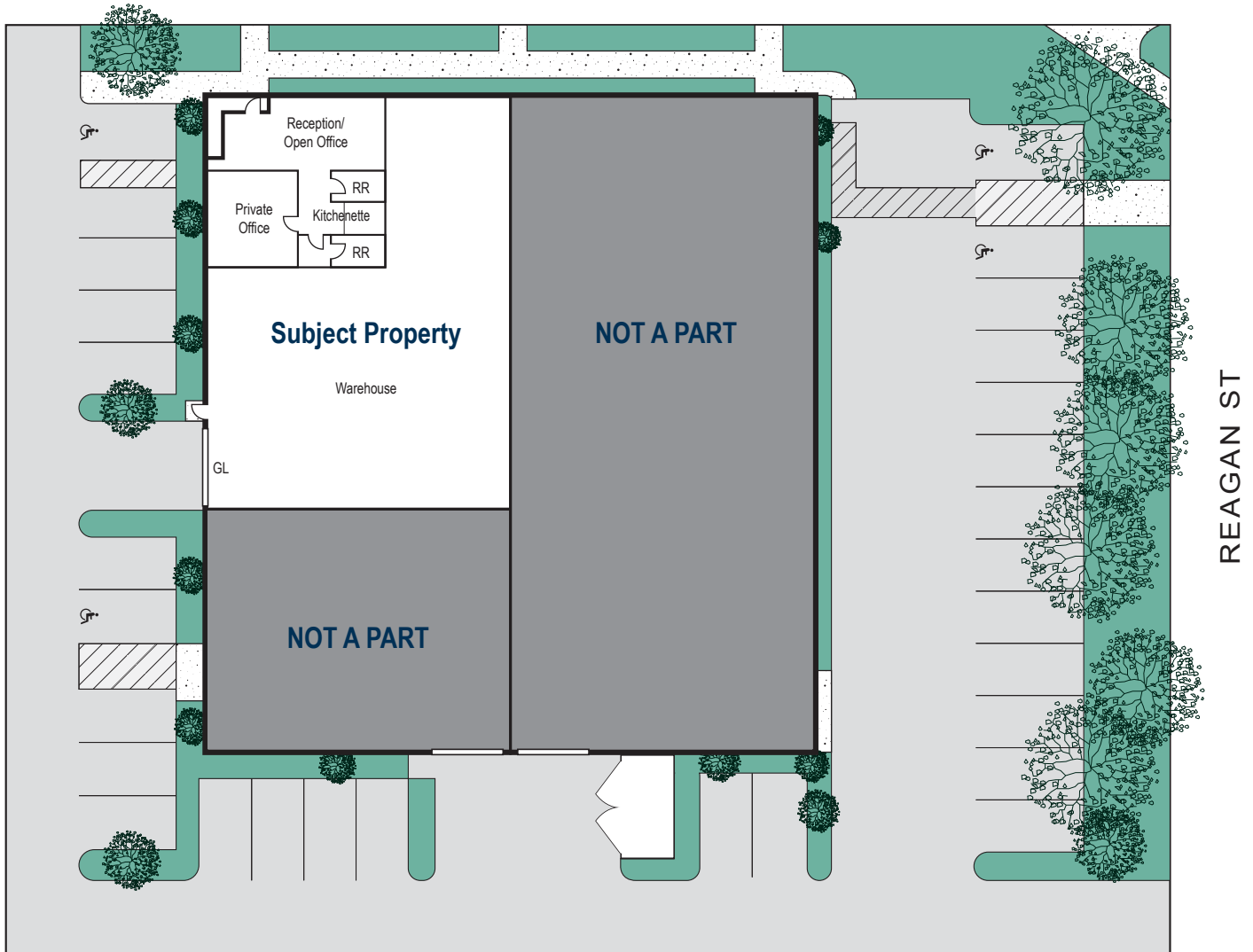

\*Plan not to scale

**MIKE BOUMA, SIOR**  
Senior Vice President  
714.935.2340  
mbouma@voitco.com  
Lic. #01070753

**SEBASTIAN LOZANO**  
Associate  
714.935.2303  
slozano@voitco.com  
Lic. #02143474

**LOREN CARGILE**  
Vice President  
714.935.2306  
lcargile@voitco.com  
Lic. #01434329

**Voit**  
REAL ESTATE SERVICES