

333 & 501

E. CERRITOS AVE., ANAHEIM FOR LEASE

MAJOR RENOVATIONS STARTED! COMPLETION EXPECTED AUGUST 2023



**±18,410 SF INDUSTRIAL BUILDING ON A 93,915 SF (2.15 AC) LAND PARCEL
WITH HUGE SECURED OUTDOOR STORAGE YARD**

Voit
REAL ESTATE SERVICES

BC
BOUMA CAPUTO

ADDRESS	333 & 501 E. Cerritos Avenue, Anaheim, CA 92805
BUILDING SIZE	± 18,410 SF
OFFICE SIZE	± 3,675 SF (Can be Modified to Suit)
LAND SIZE	± 93,915 SF (2.15 AC)
PARCEL NUMBERS	082-130-31 082-140-37
LOADING	5 Ground Level Doors (Possibly Expandable) 1 Dock High Door
CLEAR HEIGHT	14' - 15'
ELECTRICAL	Two (2) Electrical Panels 1,000 Amp and 600 Amp (Tenant to Verify Power)
YARD	Huge Secured Fenced Yard
ZONING	I - Industrial

CONDITIONAL USE PERMIT (CUP) 1

Existing Conditional Use Permit (CUP) on 501 East Cerritos for an automobile sales company. (Buyer must independently verify its proposed use is allowable under CUP & Zoning).

CONDITIONAL USE PERMIT (CUP) 2

Existing Conditional Use Permit (CUP) on 333 East Cerritos for a building material storage yard. (Buyer must independently verify its proposed use is allowable under CUP & Zoning).

- **MAJOR RENOVATION UNDERWAY:** The ownership intends to complete major renovation of the building and yard
- **BUILD TO SUIT OFFICES AVAILABLE:** The ownership will consider re-constructing the office area to suit a tenant's specific needs
- **OVERSIZED LAND PARCEL:** The property is an oversized ± 93,915 SF (2.15 AC) parcel with only 21% of building coverage currently
- **DIVISIBLE BUILDINGS:** The building has the potential to be divided, offering flexibility for future expansion or separation of business units
- **HUGE FENCED YARD:** The extra large land parcel and large secured yard allows for various types of outdoor storage needs
- **FLEXIBLE ZONING:** The Industrial Zoning allows for an array of uses that are not allowed in many other industrial districts in Orange County (please review potential uses with the city of Anaheim)
- **EXCELLENT LOCATION:** The property is centrally located in the City of Anaheim, with immediate access to the Santa Ana (5), Orange (57), and Garden Grove (22) freeways. Extensive amenities located nearby, including the Tile Mile, Anaheim Convention Center, Disneyland, Anaheim Stadium, A-town, the Platinum Triangle, and a multitude of nearby restaurants

PARCEL & LOCATION MAP

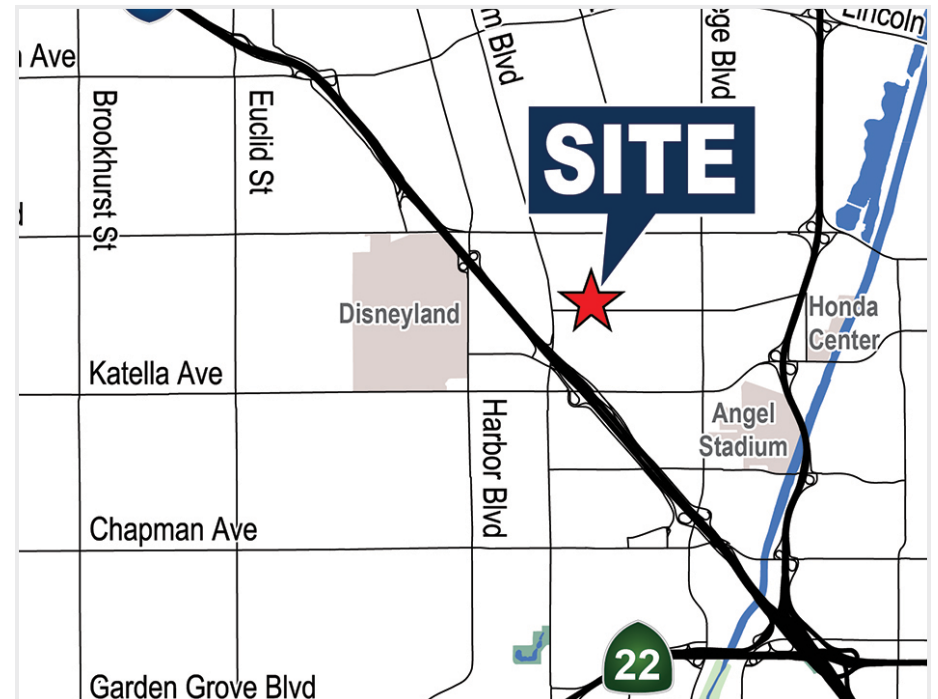
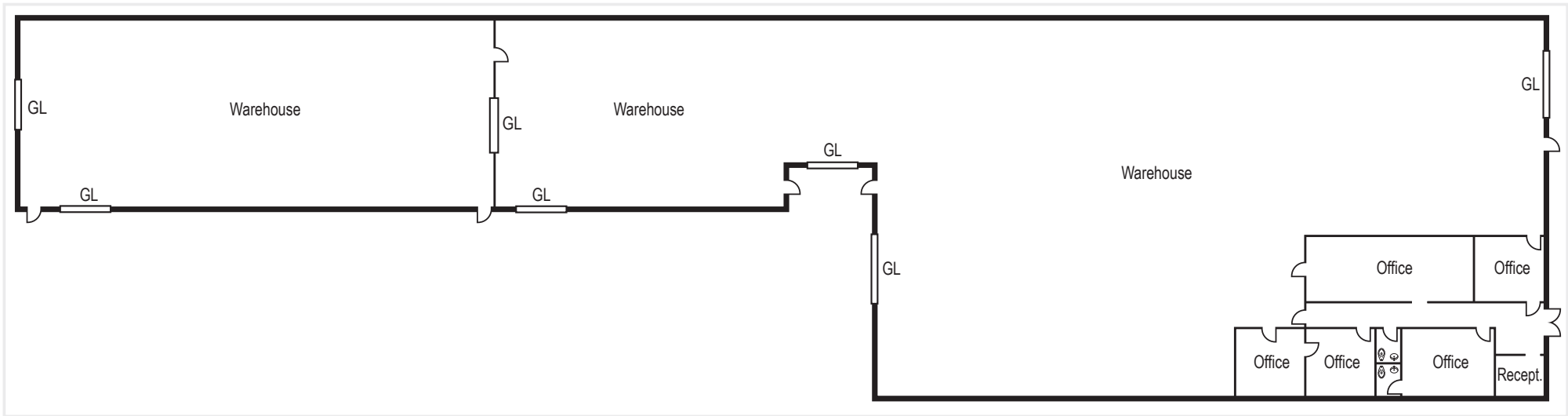

333 & 501

E. CERRITOS AVE., ANAHEIM FOR LEASE



Cerritos Ave

Voit
REAL ESTATE SERVICES

BC
BOUMA CAPUTO

Mike Bouma, SIOR
Senior Vice President | Partner
Lic #01070753
714.935.2340
mbouma@voitco.com

Paul Caputo, MBA
Senior Vice President | Partner
Lic #01196935
714.935.2332
pcaputo@voitco.com

2400 E. Katella Ave., Suite 750, Anaheim, CA 92806 • 714.978.7880 • 714.978.9431 Fax | www.voitco.com

Licensed as Real Estate Salespersons by the DRE. The information contained herein has been obtained from sources we deem reliable. While we have no reason to doubt its accuracy, we do not guarantee it. ©2023 Voit Real Estate Services, Inc. All Rights Reserved. Lic. #01991785